

Call'd. London Land

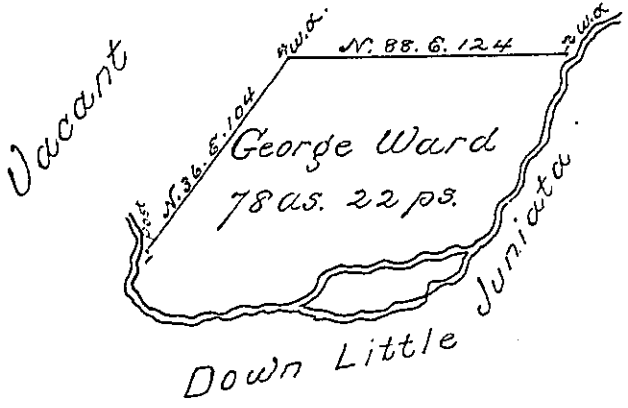

Courses up the River

- S. 28. W. 105
- S. 70. W. 58
- N. 59. W. 25
- S. 71. W. 35
- N. 75. W. 35
- N. 29. W. 15

Situated on little Juniata River including an Island in said river adjoining the London land on the North including an improvement made by Cheny in Bedford County containing Seventy Eight acres & 22 p. & usual allowance of Six p. for Roads Surveyed the 22d. of Novr. 1786 In pursuance of a Warrant dated Sept. 26th. 1786.

George Woods U.S.
John Lukins Esqr. S.G.

IN TESTIMONY that the above is a copy of the original remaining on file in the Department of Internal Affairs of Pennsylvania, made conformably to an Act of Assembly approved the 16th day of February, 1833, I have hereunto set my Hand and caused the Seal of said Department to be affixed at Harrisburg, this third day of July 1900

James W. Latta
Secretary of Internal Affairs.